



MICHAEL J. TURNER, B.SC., P.ENG., LEED® ACCREDITED PROFESSIONAL
BUILDING SCIENCE / FIELD SERVICES LEADER
PARTNER

QUALIFICATIONS

Mike is a Professional Engineer with over 15 years of Building Science experience in both design and construction. He has previously worked as a contractor and building restoration consultant. Having joined our team at Manasc Isaac to lead our in-house High Performance Building Science consultancy, Mike is also in charge of our Construction Administration group comprised of ten individuals.

Mike has worked in the curtain wall industry, as well as in consulting, and has an exceptional grasp of the integration of design and construction considerations in cold climate building envelopes. Applying extensive experience in the investigation of building envelope failures, Mike works with builders to ensure that our projects are executed and perform as well as they are designed.

Mike leads the Architectural Engineering and Building Science team at Manasc Isaac and works as part of the integrated design teams on many of Manasc Isaac's sustainable buildings. Mike is also involved in performance peer reviews on most Manasc Isaac construction documents and leads Construction partnering sessions where he works with trade contractors to ensure a clear understanding of building envelope details before construction.

EDUCATION

- 2010 Value Methodology, Save International
- 2006 LEED® Accredited Professional
- 2002 Construction Contract Administration Certificate, Faculty of Extension, University of Alberta
- 1995 Bachelor of Science, Civil Engineering (Co-op), University of Alberta

PROFILE OF PROFESSIONAL ACTIVITIES

2006 – Present, Manasc Isaac Architects Ltd.

- Provides building envelope design consulting services to the firm.
- Manages the firm's field services for projects during construction.
- Projects include:
 - ATCO Electric, Lloydminster
 - Athabasca University Academic Research Centre, Athabasca
 - Athabasca University Main Campus Lab Renovation, Athabasca
 - NAIT Alternative Energy Centre, Edmonton
 - Federal Building Feasibility Study, Edmonton
 - Emergency Operations Centre – LEED® Silver Expected, Calgary
 - Southwest Yard Storage & Maintenance Building, Edmonton
 - Slave Lake Government Centre and Library – LEED® Silver Expected, Slave Lake
 - Stony Plain Memorial Composite High School, Stony Plain
 - CV Technologies Headquarters, Edmonton
 - The Water Centre – LEED® Gold, Calgary
 - East Edmonton Primary Health Centre, Edmonton
 - Athabasca University Administration Wing, Athabasca
 - Pembina Hall Phase 2, University of Alberta, Edmonton
 - Hearthstone Affordable Housing, Grande Prairie



PROFILE OF PROFESSIONAL ACTIVITIES (CONTINUED)

2004 – 2006, Read Jones Christoffersen Ltd., Edmonton
Design Engineer – Building Science and Restoration

- Provided consulting services in the evaluation and restoration of existing building envelopes and structures as well as design for new building envelope systems.
- Involved in a number of building evaluations, design, and restoration projects, including both building structures and building envelopes for a range of low and high-rise buildings.
- Design and restoration work encompasses wood, steel and concrete structures, as well as a variety of exterior wall systems.

1995 – 2003, Visionwall Corporation, Edmonton
Project Manager (1995 – 2002)
Manager, Projects Group (2002 – 2003)

- Primarily involved with the design and application of high-performance curtainwall, skylight, and window systems for projects in North America, Europe, and Asia.
- Due to the high level of design, integration was often required between the various exterior envelope systems.

SELECTED PROJECT EXPERIENCE:

Convention Centres:

- Omaha Convention Centre, Omaha
- Palais des Congrès de Montréal, Montreal
- Pioneer Carver Convention Centre, Johnston

Educational:

- Pembina Hall Phase 2, University of Alberta, Edmonton
- Civil Engineering Building, University of Alberta, Edmonton
- Computing Sciences, University of Alberta, Edmonton
- Education Car Park, University of Alberta, Edmonton
- National Institute for Nanotechnology, University of Alberta, Edmonton
- Rutherford Library Galleria, University of Alberta, Edmonton
- Bellevue Community College Building A, Bellevue
- King's University College Expansion, Edmonton
- Athabasca University Administration Wing, Athabasca
- Holyrood School Modernization, Edmonton

Healthcare:

- Bassett Community Hospital – US Army, Fort Wainwright
- United Heart Hospital Expansion, St. Paul, MN
- East Edmonton Primary Health Centre, Edmonton

Hotels:

- One Wall Centre, Vancouver, B.C.

**PROFILE OF PROFESSIONAL
ACTIVITIES – CONTINUED**

SELECTED PROJECT EXPERIENCE (CONTINUED):

Office Buildings:

- A/E Plaza – Reimagine Feasibility Study, Edmonton
- Stanley A. Milner Library – Reimagine Feasibility Study, Edmonton
- Canadian Western Bank Building, Edmonton
- Color Converting Industries Head Office, Des Moines
- Enbridge Tower, Edmonton
- Jarvis Building, Edmonton
- Nortel Carling Campus Lab 9 Expansion, Nepean
- North American Construction Head Office, Acheson
- Norwest Mortgage, West Des Moines
- Petroleum Plaza, Edmonton
- Red Deer City Hall, Red Deer
- Scotia Place, Edmonton
- WCB Central Building, Edmonton
- CV Technologies, Edmonton
- The Water Centre – LEED® Gold, Calgary
- Slave Lake Government Centre & Library – LEED® Silver Expected, Slave Lake

Residential:

- Claridge House, Edmonton
- Meadowlark Village, Edmonton
- Perron Place, St. Albert
- Qualico Developments – various locations in Alberta
- The Uplands, Edmonton
- Hearthstone Affordable Housing, Grande Prairie
- Swerve Residence, Red Deer

International Projects:

- Amundsen-Scott South Pole Station, Antarctica
- S-Project, Seoul, Republic of Korea

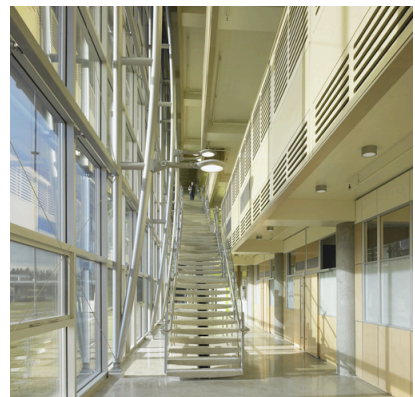
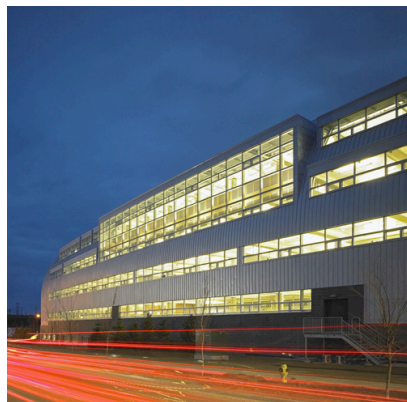

The Water Centre, Calgary